



cover guard®

EVERY SKILL MATTERS

3 references

WORK'R RANGE

3 head protection references

44 garment references

10 gloves references

1 pair of shoes

44 references

10 references

1 reference

Uncover your skills



DESIGNING OUR PRODUCTS

Example:

5TLP01R

TELICA II



↙ ↗ **-23%**

of carbon footprint compared to the average for the Coverguard WORKWEAR range

29kgCO₂e

carbon impact per trouser

-3 981 kgCO₂e/year

(Sur la base des ventes de TELICA en 2023)



Discover the full range WORK'R

LCA & product design



Carbonfact platform

- + **Product Life Cycle Assessment (LCA):** to measure the environmental impact of our products.
- + **Compliance guarantee:** results comply with regulations such as CSRD and the AGECL law
- + **Decarbonisation:** ecodesign to reduce the carbon footprint of our products.

— Carbonfact

Traceability



Retraced platform

- + **Mapping:** identification of production sites right down to the raw material.
- + **Securing:** tracking the entire value chain for each order.
- + **Transparency:** access to traceability via a QR code or link.

— retraced

Sustainable packaging



LESS by Coverguard

- + **LESS project:** reducing the environmental footprint of packaging.
- + **TELICA II packaging:** 50% recycled plastic bag, minimalist printing and optimized format

Recycled & biobased materials



GRS & RCS Certification

- + **Recycled material:** coming from plastic bottles with certified origin.
- + **Guarantee of good production conditions:** social and environmental management throughout the supply chain.

WORK'R RANGE

Products made from **recycled materials**

1CLD400

CLAW CUT D 400



Certified by
Ecocert Greenlife 267872
20% RCS recycled polyester



BENEFITS

- RECYCLED: 20% RCS recycled polyester
- KNIT GAUGE 21: Second skin feel for exceptional dexterity
- NITRILE SANDY PALM COATING: Excellent grip in dry and slightly oily environment
- LONG CROTCH BETWEEN THUMB AND INDEX: improved grip and tear prevention for maximum durability



STANDARDS

EN388:2016 + A1:2018
4.X.4.2.D.
EN407:2020
X1.X.X.X.X



SIZES

6 → 12

1CLF400

CLAW CUT F 400



Certified by
Ecocert Greenlife 267872
18% RCS recycled polyester



BENEFITS

- RECYCLED: 18% RCS recycled polyester
- KNIT GAUGE 21: Second skin feel for exceptional dexterity
- NITRILE SANDY PALM COATING: Excellent grip in dry and slightly oily environment
- LONG CROTCH BETWEEN THUMB AND INDEX: improved grip and tear prevention for maximum durability



STANDARDS

EN388:2016 + A1:2018
4.X.4.2.F.
EN407:2020
X1.X.X.X.X



SIZES

6 → 12

1CL9400

CLAW CUT A9 400



Certified by
Ecocert Greenlife 267872
16% RCS recycled polyester



BENEFITS

- RECYCLED: 16% RCS recycled polyester
- CUT A9: Highest level of cut protection in the world (standard ANSI)
- GAUGE 18: Comfort and high dexterity
- NITRILE SANDY PALM COATING: Excellent grip in dry and slightly oily environment
- LONG CROTCH BETWEEN THUMB AND INDEX: Improved grip and tear prevention for maximum durability



STANDARDS

EN388:2016 + A1:2018
4.X.4.3.F.
EN407:2020
X1.X.X.X.X



SIZES

6 → 12

1CLD700

CLAW CUT D 700



Certified by
Ecocert Greenlife 267872
11% RCS recycled polyester



BENEFITS

- RECYCLED: 11% RCS recycled polyester
- GAUGE 18: Second skin feel for exceptional dexterity
- LATEX DOUBLE PALM COATING SANDY FINISH: Excellent grip in dry and wet environments



STANDARDS

EN388:2016 + A1:2018
3.X.4.2.D.
EN407:2020
X1.X.X.X.X



SIZES

6 → 12

1CLF707

CLAW CUT F 707



Certified by
Ecocert Greenlife 267872
16% RCS recycled polyester



BENEFITS

- RECYCLED: 16% RCS recycled polyester
- GAUGE 18: Comfort and high dexterity
- DOUBLE LATEX COATING: Excellent grip in dry and wet environments and waterproof



STANDARDS

EN388:2016 + A1:2018
3.X.4.2.F.
EN407:2020
X1.X.X.X.X



SIZES

6 → 12

1CLD500

CLAW CUT D 500



Certified by
EcoCert Greenlife 267872
14% RCS recycled polyester



BENEFITS

- RECYCLED: 14% RCS recycled polyester
- GAUGE 21: Second skin sensation for excellent dexterity
- NITRILE DOUBLE PALM COATING WITH SANDY FINISH: Excellent grip in dry and oily environment, oil and liquidproof
- LONG CROTCH BETWEEN THUMB AND INDEX: Improved grip and tear prevention for maximum durability



STANDARDS

EN388:2016 + A1:2018
4.X.4.2.D.
EN407:2020
X1.X.X.X.X



SIZES

6 → 12

1CLF500

CLAW CUT F 500



Certified by
EcoCert Greenlife 267872
16% RCS recycled polyester



BENEFITS

- RECYCLED: 16% RCS recycled polyester
- GAUGE 21: Second skin sensation for excellent dexterity
- NITRILE DOUBLE PALM COATING WITH SANDY FINISH: Excellent grip in dry and oily environment, oil and liquidproof
- LONG CROTCH BETWEEN THUMB AND INDEX: Improved grip and tear prevention for maximum durability



STANDARDS

EN388:2016 + A1:2018
4.X.4.2.F.
EN407:2020
X1.X.X.X.X



SIZES

6 → 12

1CLF505

CLAW CUT F 505



Certified by
EcoCert Greenlife 267872
16% RCS recycled polyester



BENEFITS

- RECYCLED: 16% RCS recycled polyester
- KNIT GAUGE 18: Comfort and excellent dexterity
- Nitrile double coating: Excellent grip in dry and oily environment, oil and liquidproof
- LONG CROTCH BETWEEN THUMB AND INDEX: Improved grip and tear prevention for maximum durability



STANDARDS

EN388:2016 + A1:2018
4.X.4.3.F.
EN407:2020
X1.X.X.X.X



SIZES

6 → 12

1LACW00

EUROLITE L900



Certified by
Ecocert Greenlife 267872
30% RCS recycled polyester



BENEFITS

- RECYCLED: RCS Blended certified product
- EXCELLENT GRIP in dry and wet environments
- CHEMICAL-FREE COATING



STANDARDS

EN388:2016
2.1.3.1.X
EN407:2020
X.2.X.X.X.X



SIZES

7 → 11

1HEFROP

EUROHEAT GREEN



Certified by
Ecocert Greenlife 267872
13% RCS recycled polyester and
10% RCS recycled cotton



BENEFITS

- RECYCLED: 13% RCS recycled polyester and 10% RCS recycled cotton
- COMFORTABLE: moisture management with 75% cotton liner
- GOOD GRIP – latex crinkle coated
- POLYVALENT: CUT B and heat contact 2
- THERMAL CONTACT insulation 250°C / 15 sec



STANDARDS

EN388:2016
3.X.4.2.B
EN407:2020
X.2.X.X.X.X



SIZES

7 → 11

9FLE1R

CLAW FLEX LOW



Certified by
Ecocert Greenlife 267872
These shoes contain
23% RCS recycled polyester and
7% RCS recycled TPU



BENEFITS

- RCS certified: upper made with recycled materials
- SOFT PU/PU outsole : great cushioning and comfort
- FRONTAL OVERPROTECTION: extended durability
- WIDE CLEATS AND FLEX LINES: optimized adaptability to the ground
- BREATHABLE POLYESTER MESH UPPER: laboratory tested for optimal airflow (laboratory tested)



STANDARDS

EN ISO 20345:2022
S1PS FO SR



SIZES

35 → 48

5SCJ01R

S-CLAW



©TextileExchange
Certified by Ecocert Greenlife
267872
92% GRS recycled polyester



BENEFITS

- RECYCLED: GRS-certified
- WATERPROOF: 10 000mm high-performance membrane
- BREATHABLE: 11 000g/m²/24H membrane + underarm ventilation
- ERGONOMIC: removable hood + helmet-friendly



STANDARDS

EN 343:2019
4.4.x



SIZES

S → 4XL

5SCP01R

S-CLAW



©TextileExchange
Certified by Ecocert Greenlife
267872
92% GRS recycled polyamide



BENEFITS

- RECYCLED: GRS-certified
- COMFORT: full-stretch fabric
- PROTECTION: EN 14404:2024 + knee pad pockets in Cordura®
- UV RESISTANT: certified EN 13758-2 UPF 40+
- FUNCTIONAL: raised waistband + possibility to extend by 5cm + multiple tool pockets



STANDARDS

EN 14404-3:2024
EN 13758-2 UPF 40+



SIZES

S → 4XL

5AZU45R

AZUKI II



BENEFITS

- RECYCLED: GRS-certified
- RESISTANCE: waterproof Ripstop fabric
- COMFORT AND WARMNESS: fleece lining + raglan sleeves
- PROTECTION: extended back + elasticated armhole



STANDARDS

EN 14058:2017
2.3.x.x



SIZES

S → 4XL

5GOM45R

GOMA II

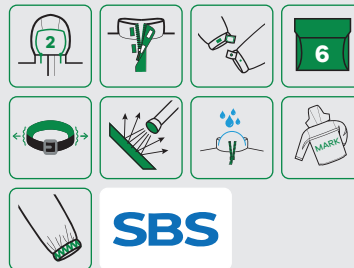

BENEFITS

- RECYCLED: GRS-certified
- RESISTANT AND WATERPROOF: coated Ripstop fabric + waterproof seams
- WARM: dense quilting, standardised
- COMFORT: raglan sleeves



STANDARDS

EN 14058:2017
2.3.x.x
EN 343:2019
3.1.x



SIZES

S → 4XL

5YUZ45R / 5YUZ31R / 5YUZ52R

YUZU II



BENEFITS

- RECYCLED: GRS-certified
- RESISTANT AND WATERPROOF: coated Ripstop fabric + waterproof seams
- COMFORT: fleece lining + raglan sleeves
- PROTECTION: extended back



STANDARDS

EN 14058:2017
2.3.x.x
EN 343:2019
3.1.x



SIZES

S → 4XL

5YUZ52R

5YUZ31R

5YUZ45R

5TLJ01R

TELICA II



BENEFITS

- RECYCLED: GRS-certified
- COMFORT: main fabric contains elastane
- FUNCTIONAL: many closed pockets
- PROTECTION: extended back in Oxford



SIZES

XS → 4XL

5TLP01R / 5TLP31R

TELICA II

5TLP01R



5TLP31R

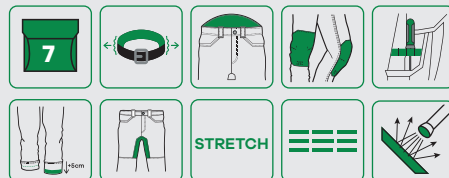

BENEFITS

- RECYCLED: GRS-certified
- COMFORT: contains stretch + ultra stretchy crotch
- PROTECTION: Oxford knee pockets + many reinforcements
- FUNCTIONAL: raised waistband + possibility to extend by 5cm + multiple tool pockets



STANDARDS

EN 14404:2024 + A1:2010
TYPE 2



SIZES

S → 4XL

5CAJ01R

CASITA II

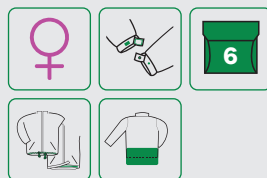

BENEFITS

- RECYCLED: GRS-certified
- COMFORT: main fabric contains elastane
- FUNCTIONAL: many closed pockets
- PROTECTION: extended back in Oxford



SIZES

XS → 2XL

5CAP01R

CASITA II

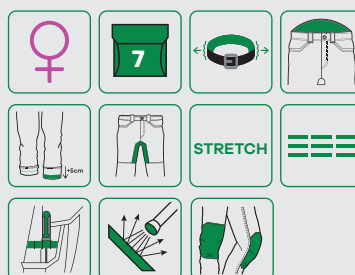

BENEFITS

- RECYCLED: GRS-certified
- COMFORT: contains stretch + elastane + ultra-stretch crotch
- PROTECTION: Oxford knee pockets + many reinforcements
- FUNCTIONAL: raised waistband + possibility to extend by 5cm + multiple tool pockets



STANDARDS

EN14404:2004 + A1:2010
TYPE 2



SIZES

XS → 2XL

5PYT120

PYTHON



BENEFITS

- RECYCLED: GRS-certified
- TECHNICAL: membrane printed with Graphene, known for its exceptional properties
- WATERPROOF: 10,000 mm high-performance membrane



STANDARDS

EN 343:2019
4.4.x



SIZES

S → 4XL

5BAN01R / 5BAN38R

BANJO



5BAN01R



5BAN38R

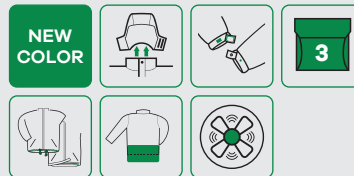

BENEFITS

- RECYCLED: GRS-certified
- WATERPROOF: 10,000mm high-performance membrane
- WARM AND BREATHABLE: fleece interior + 5,000g/m²/24H membrane + underarm ventilation
- ERGONOMIC: removable hood + helmet-friendly



STANDARDS

EN14058:2017
1.3.x.x



SIZES

S → 4XL

5KOA120 / 5KOA310

KOALA



5KOA120



5KOA310



BENEFITS

- RECYCLED: GRS-certified
- SOFT AND WARM: thick fleece with anti-pilling treatment
- COMFORT: freedom of movement with raglan sleeves



STANDARDS

EN14058:2017
1.1.x.x



SIZES

S → 3XL

5NEB16R / 5NEB17R

NEBULO



5NEB16R

5NEB17R

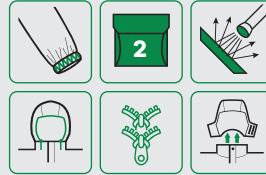

BENEFITS

- **RECYCLED:** GRS-certified polyester outer and inner fabrics
- **PERFORMANCE:** high waterproof and breathable membrane (5,000 mm – 3,000 g/m²/24h)
- **COMFORT:** segmented bands for better flexibility
- **ERGONOMIC:** removable hood, helmet-friendly



STANDARDS

EN 20471:2013 + A1:2016
CLASS 2 (S), CLASS 3 (M+)
EN 14058:2017
1.3.x.x



SIZES

S → 4XL

5KAJ16R / 5KAJ17R

KAZAN II



5KAJ16R

5KAJ17R



BENEFITS

- **RECYCLED:** GRS-certified
- **WATERPROOF:** coated Oxford + taped seams
- **COMFORT:** warm fleece lining + ribbed cuffs
- **FUNCTIONAL:** convertible into a vest + marking flap



STANDARDS

EN 20471:2013 + A1:2016
CLASS 2 (Bodywarmer)
CLASS 3 (Jacket)
EN 14058:2017
3.3.x.WP
EN 343:2019
3.1.x



SIZES

S → 4XL

5ARO16R / 5ARO17R

AURO



5ARO16R

5ARO17R



BENEFITS

- **RECYCLED:** GRS-certified
- **WATERPROOF:** 8,000 mm – 5,000 g/m²/24h
- **FUNCTIONAL:** foldable hood and windproof cuffs
- **ANTIPOULING:** contrasting colors at pocket entries



STANDARDS

EN 20471:2013 + A1:2016
CLASS 3
EN 343:2019
3.3.x



SIZES

S → 7XL

5SOM16R / 5SOM17R / 5SOM13R

SOMO



5SOM13R

5SOM16R

5SOM17R



50% GRS recycled polyester and
50% cotton



BENEFITS

- RECYCLED: GRS-certified.
- PROTECTION: EN 13758-2 UPF40+ certified
- BREATHABLE: good ventilation thanks to the mesh underarms
- COMFORT: segmented bands provide flexibility
- ANTIFOULING: anti-dirt inserts including collar



STANDARDS

EN 20471:2013 + A1:2016
CLASS 2 (S), CLASS 3 (M+)
EN 13758-2 UPF 40+



SIZES

S → 4XL

5SUN17R / 5SUN16R / 5SUN13R

SUNO II



5SUN13R

5SUN16R

5SUN17R



100% GRS recycled polyester



BENEFITS

- RECYCLED: GRS-certified.
- BIRD-EYE KNIT: 100% recycled polyester GRS – 140 g/m² – UPF 40+
- MESH: 100% polyester (armpit)
- RETRO-REFLECTIVE BANDS: segmented microbead bands, 5 cm



STANDARDS

EN 20471:2013 + A1:2016
CLASS 2 (S), CLASS 3 (M+)
EN 13758-2 UPF40+



SIZES

S → 3XL

5KOM16R / 5KOM17R / 5KOM13R

KOMO II



5KOM13R

5KOM16R

5KOM17R



50% GRS recycled polyester and
50% cotton



BENEFITS

- RECYCLED: GRS-certified
- PROTECTION: EN 13758-1 UPF40+ certified
- BREATHABLE: good ventilation thanks to the mesh underarms
- COMFORT: segmented bands provide flexibility
- ANTIFOULING: anti-dirt inserts including collar



STANDARDS

EN 20471:2013 + A1:2016
CLASS 2 (S), CLASS 3 (M+)
EN 13758-1 UPF 40+



SIZES

S → 4XL

5KYR17R / 5KYR16R

KYRIO II



5KYR16R

5KYR17R



100% GRS recycled polyester



BENEFITS

- RECYCLED: GRS-certified
- PROTECTION: EN 13758-2 UPF50+ certified
- BREATHABLE: good ventilation thanks to the mesh underarms
- COMFORT: segmented bands provide flexibility
- ANTIFOULING: anti-dirt inserts including collar



STANDARDS

EN 20471:2013 + A1:2016
CLASS 2
EN 13758-2 UPF 50+



SIZES

S → 3XL

5FIP17R / 5FIP16R

FIORD

5FIP16R



5FIP17R



SLIM

STRETCH

STRETCH



79% GRS recycled polyester
+ 15% polyamide and
6% elastane



BENEFITS

- RECYCLED: GRS-certified.
- COMFORT: all in stretch, segmented bands, raised belt
- PROTECTION: Ripstop with multiple reinforcements
- FUNCTIONAL: possibility to extend by 5 cm, multiple tool pockets



STANDARDS

EN 20471:2013 + A1:2016
CLASS 1 (S-XL),
CLASS 2 (2XL-4XL)
EN 14404-3:2024



SIZES

S → 4XL

WORK'R RANGE

Products made from **biobased materials**

5FLA160 / 5FLA170

FLAKE



5FLA160

5FLA170



BENEFITS

- BIOBASED: SORONA® is partly made of bio-polyester
- LIGHT AND WARM: SORONA® technology
- EFFICIENT: water-repellent with TPU membrane + tear resistance
- COMFORT: segmented bands



STANDARDS

EN ISO 20471:2013 + A1:2016
CLASS 2 (S-L), CLASS 3 (XL+)
EN14058:2017
4.3.0,191m²K/W.x



SIZES

S → 3XL

5SUM010/ 5SUM120

SUMI



5SUM010

5SUM120



BENEFITS

- BIOBASED: SORONA® is partly made of bio-polyester
- LIGHT AND WARM: SORONA® technology
- RESISTANT: Ripstop weave + reinforcement zones
- HYBRID: quilting + softshell



STANDARDS

EN14058:2017
4.2.0,196m²K/W.x



SIZES

S → 3XL

5BRA010

BRASERO



BENEFITS

- BIOBASED: SORONA® is partly made of bio-polyester
- LIGHT AND WARM: SORONA® technology
- RESISTANT: Ripstop weave + reinforcement zones
- HYBRID: quilting + Softshell



SIZES

S → 4XL

5CLT15R

CLARINET



BENEFITS

- SUSTAINABLE PRODUCTION: TENCEL® is a cellulosic fiber derived from controlled and certified woods
- BREATHABLE: TENCEL® regulates moisture absorption and release
- SOFTNESS: soft and smooth touch
- COMFORT: high elasticity



SIZES

XS → 3XL

5CLL15R

CLARINET



BENEFITS

- SUSTAINABLE PRODUCTION: TENCEL® is a cellulosic fiber derived from controlled and certified woods
- BREATHABLE: TENCEL® regulates moisture absorption and release
- SOFTNESS: soft and smooth touch
- COMFORT: high elasticity



SIZES

XS → 3XL

WORK'R RANGE

Products based on **bio-circular materials**

6LIMC8R / 6LIMS8R

LIMELUX VR



6LIMC8R



6LIMS8R

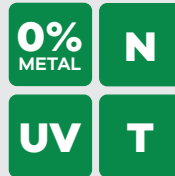

BENEFITS

- ISCC Plus-certified biocircular material-based product
- LIGHTWEIGHT (23g) and comfortable
- SIDE PROTECTION with vented eye area
- FLEXIBLE AND AUTO-ADJUSTABLE TEMPLES
- SOFT AND ADJUSTABLE NOSE PAD: anti-slip



STANDARDS

EN166:2001
EN170:2002

6OVEC8R

OVERLUX VR



6OVEC8R

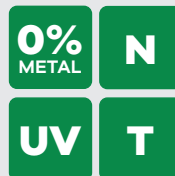

BENEFITS

- ISCC Plus-certified biocircular material-based product
- COMPATIBLE with prescription glasses
- PANORAMIC LENS with integrated side protection for wide coverage of the eye area
- ADJUSTABLE temples with soft, flexible material on the tips for optimum support



STANDARDS

EN166:2001
EN170:2002

A woman with her hair tied back, wearing clear safety glasses and a black high-tech work jacket with blue accents, stands in a warehouse aisle. She is holding a roll of brown tape and a red tool. The background is filled with tall, blurred metal shelving units.

**Uncover
your skills** 



Enabling everyone to realise
their full potential in complete safety,
because every skill matters.



PAE de la Dombes
120 rue Michel Girer
01390 Mionnay – France

T +33 (0)4 72 26 23 23

contact@coverguard-safety.com

**Discover our
CSR commitments:**

